



# Virtuoso

## OWNER'S MANUAL

CONTROL GUIDE, CABLING  
& SETUP CONFIGURATIONS



[WWW.EMERALDGUITARS.COM](http://WWW.EMERALDGUITARS.COM)

# CONTROL GUIDE

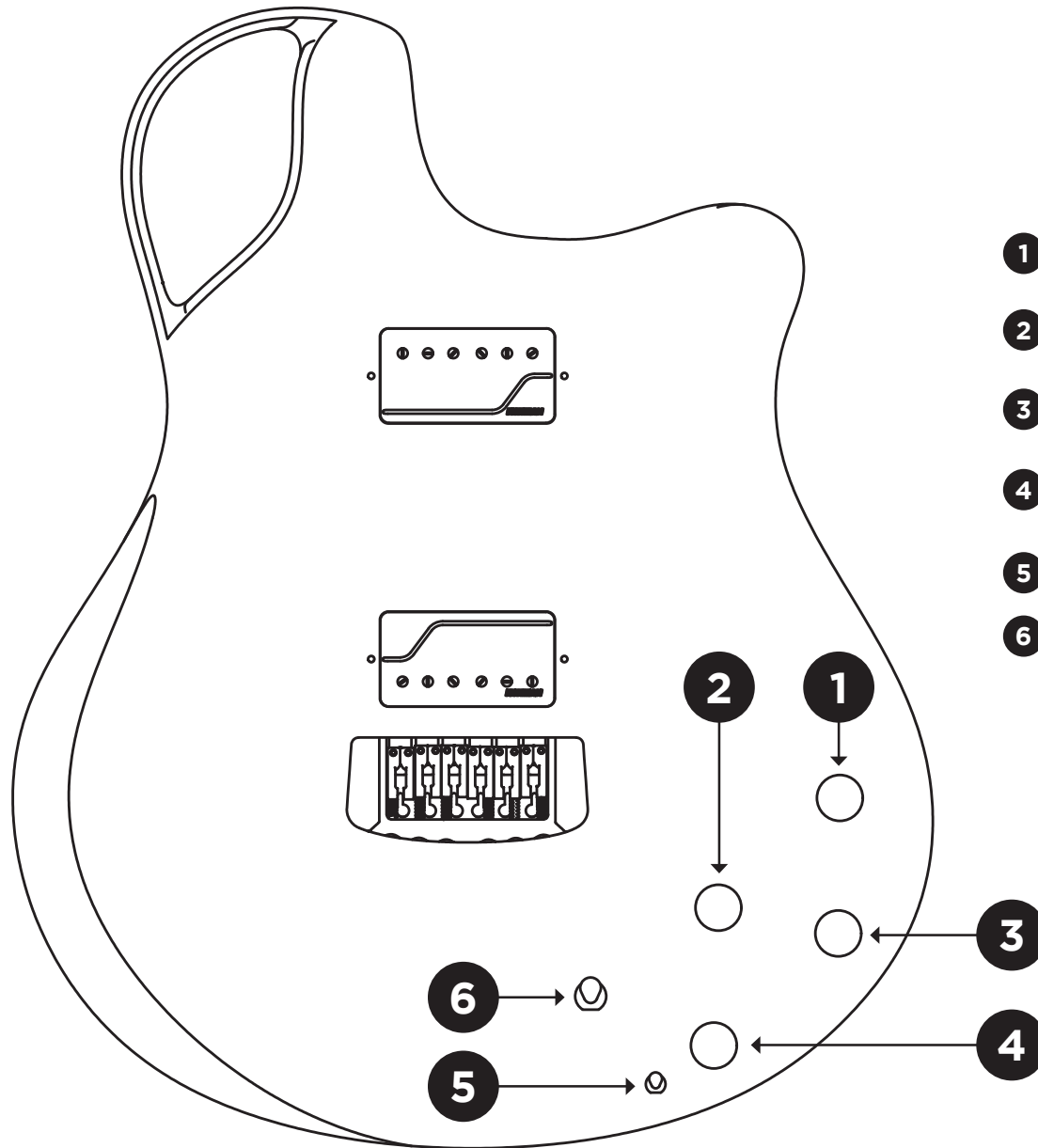

- 1 Volume Control - Graphtech Ghost Piezo**
- 2 Volume Control - Fishman Fluence Humbuckers  
+ Push/Pull - Vintage or Modern Humbuckers**
- 3 Volume Control - Midi/Synth**
- 4 Tone Control - Fishman Fluence Humbuckers  
+ Push/Pull Coil Splitting - Fishman Fluence Humbuckers**
- 5 3 Way Piezo/Mix/Humbucker Selector Switch**
- 6 3 Way Humbucker Selector Switch**

# CABLING - STEREO GUITAR CABLE

In order to send the signal of the Humbucker and Piezo pickups to individual sources (i.e Electric Amp and Acoustic Amp/PA), you will need a “Stereo Guitar Cable”.

- The simplest solution is to use a “Stereo to x2 Mono Cable”, with Stereo 1/4 inch Jack one end, splitting to 2 Mono 1/4 inch Jacks.
- Alternatively, we recommend the “K&K Dual Channel Pro ST”. This 2 channel preamp allows for a Stereo to Stereo 1/4 inch input and two standard mono guitar cable outputs. Using this preamp will protect from any signal loss and allow added volume control.

## STEREO TO X2 MONO CABLE

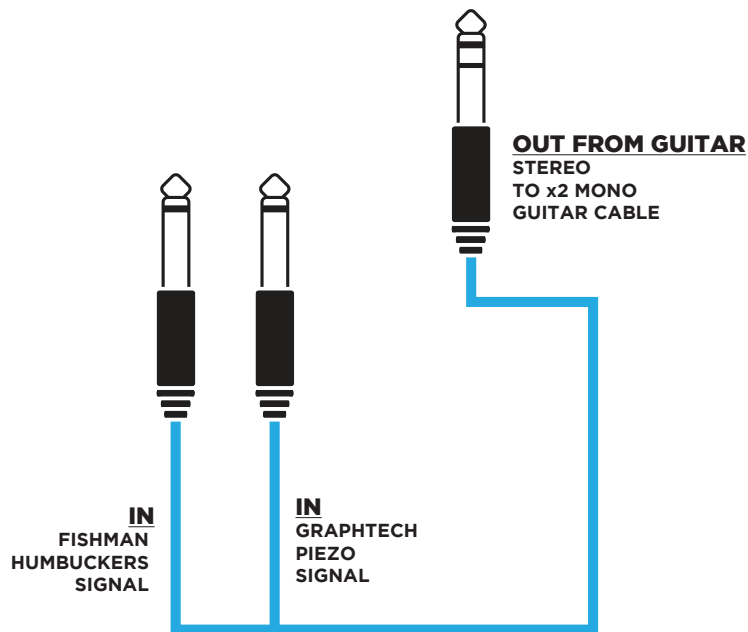

PLEASE NOTE: We have used this option to illustrate all setup options in this document.

## K&K DUAL CHANNEL PRO ST

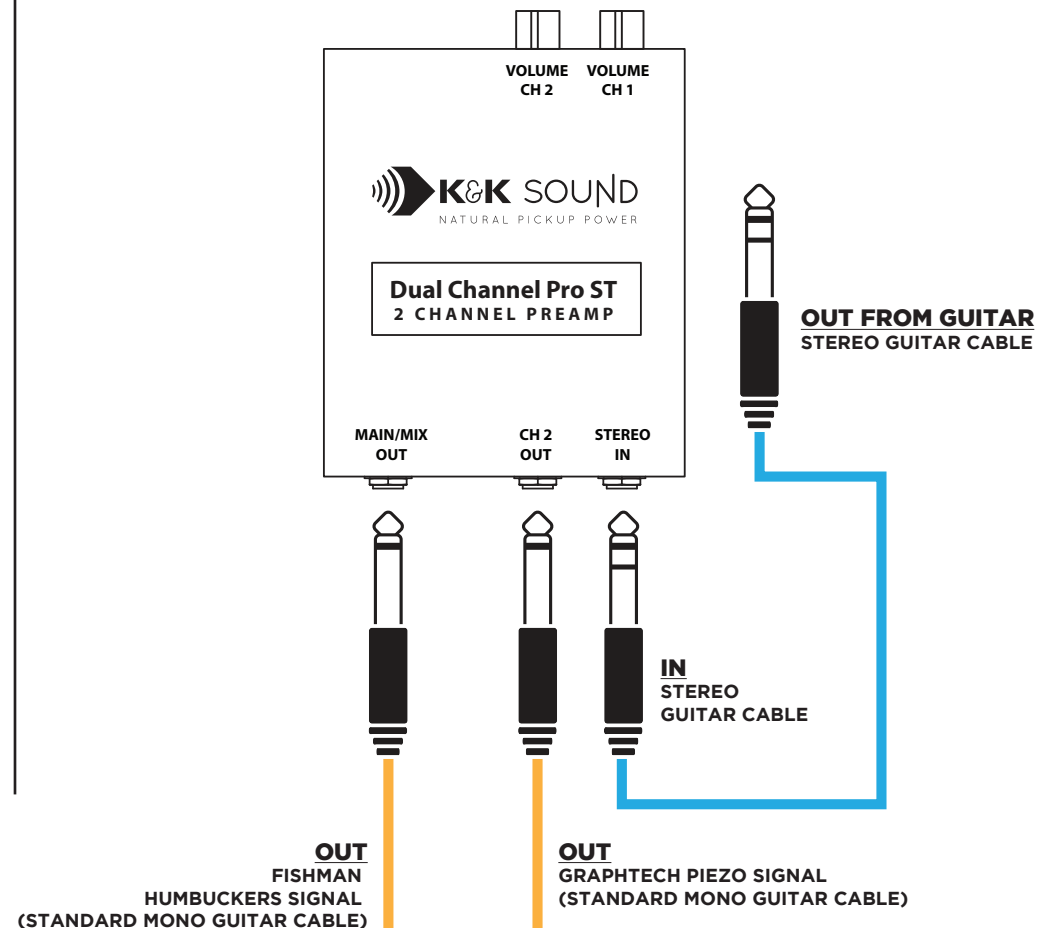

## CONFIGURATIONS: SETUP A

- Stereo Guitar Cable + 13 Pin Hexpander Output
- Route Fishman Humbuckers to a Guitar Amp
- Route Graphtech Piezo to DI or Acoustic Amp or PA
- Route 13 Pin cable to Guitar Synth Unit (Boss SY1000 or Roland GR55) - Synth Unit to DI/Acoustic Amp/PA

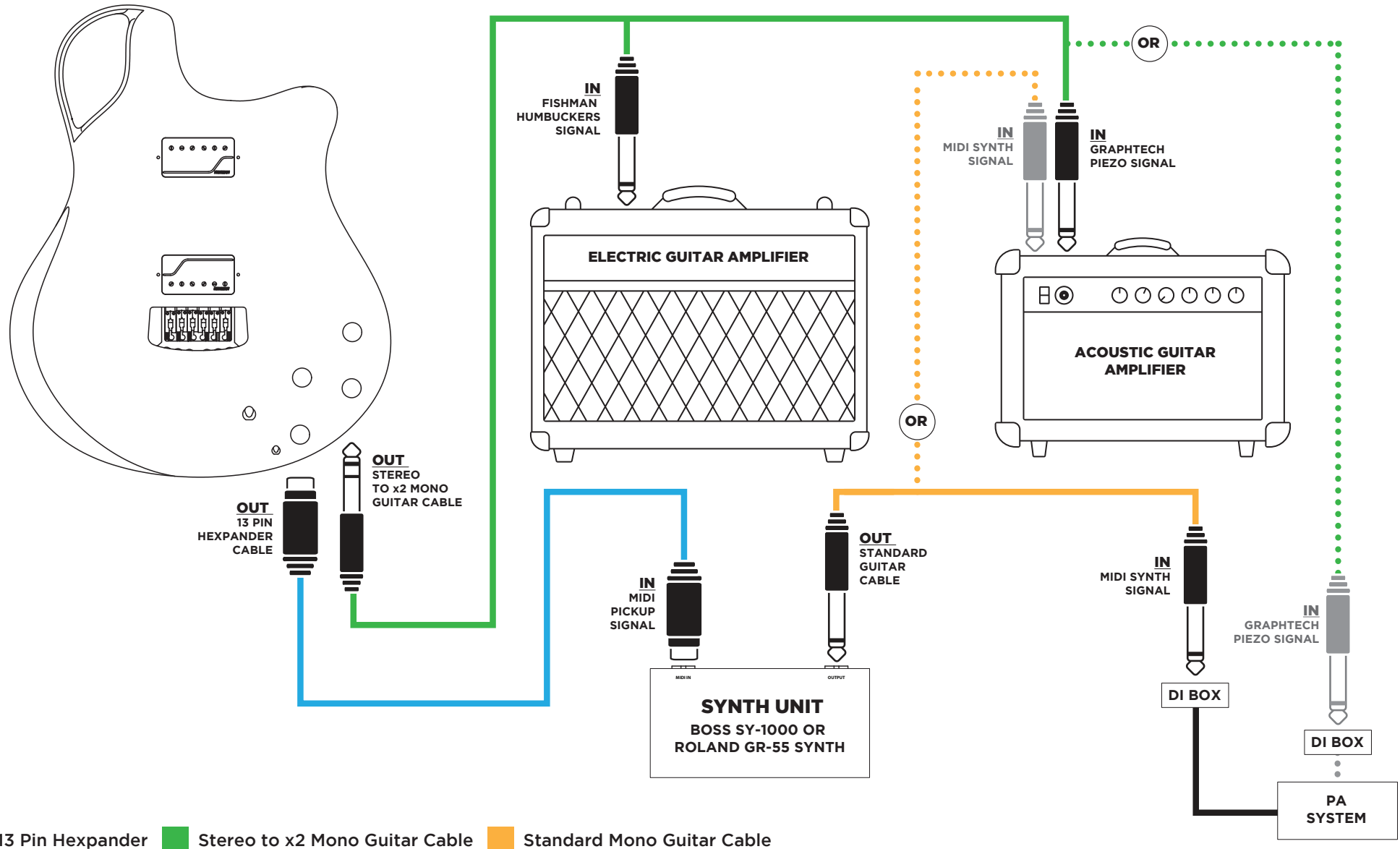

## CONFIGURATIONS: SETUP B

- Mono Guitar Cable + 13 Pin Hexpander
- Route Mono cable to Guitar Amp OR DI/PA
- Route 13 Pin cable to Guitar Synth Unit (Boss SY1000 or Roland GR55) - Synth Unit to DI/Acoustic Amp/PA

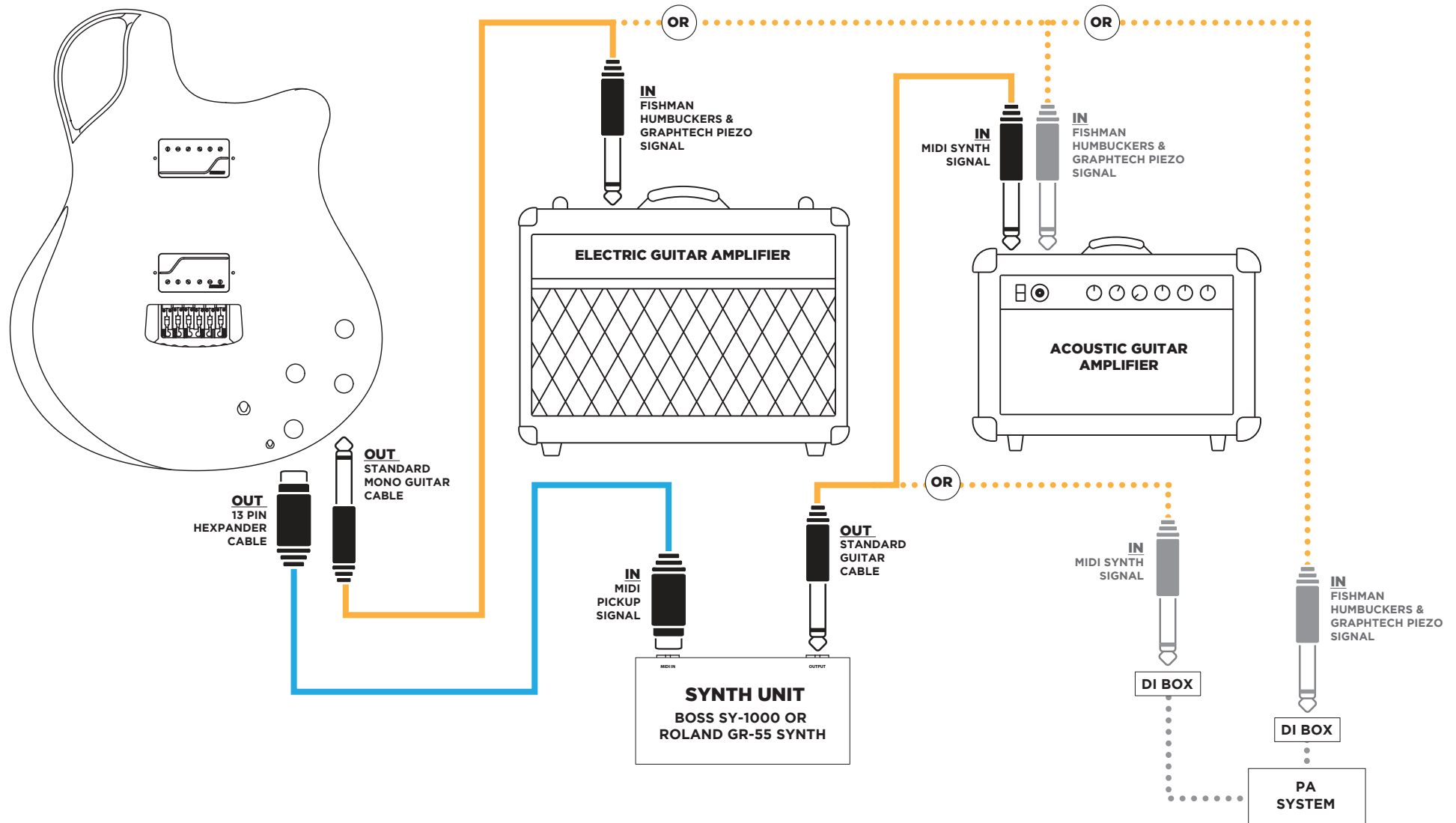



## CONFIGURATIONS: **SETUP C**

- Stereo Guitar Cable
- Route Fishman Humbuckers to a Guitar Amp
- Route Graphtech Piezo to DI or Acoustic Amp or PA
- No Synth in use

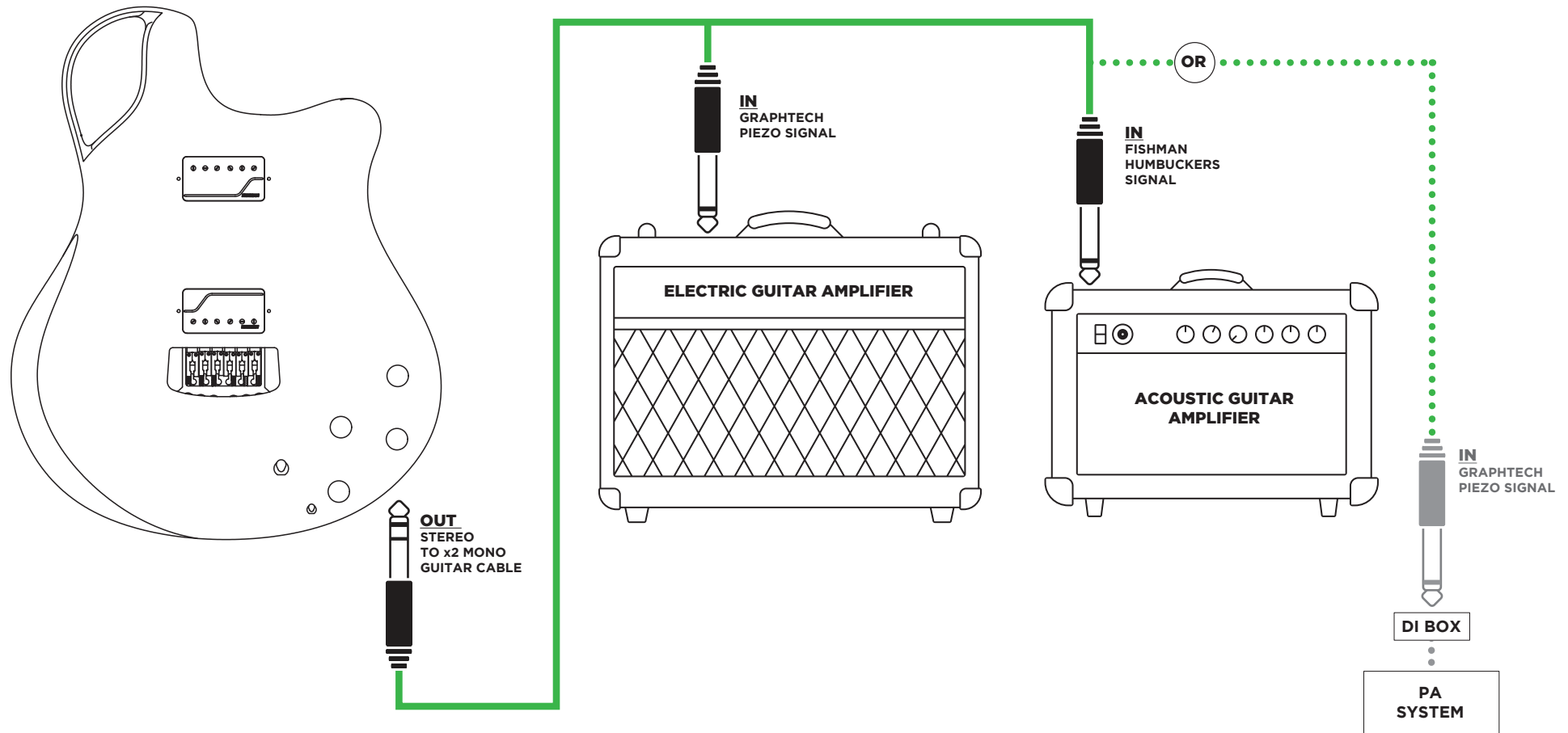

## CONFIGURATIONS: SETUP D

- Mono Guitar cable
- Route Fishman Humbuckers and Graphtech Piezo to a Guitar Amp/DI/PA
- NO Synth in use

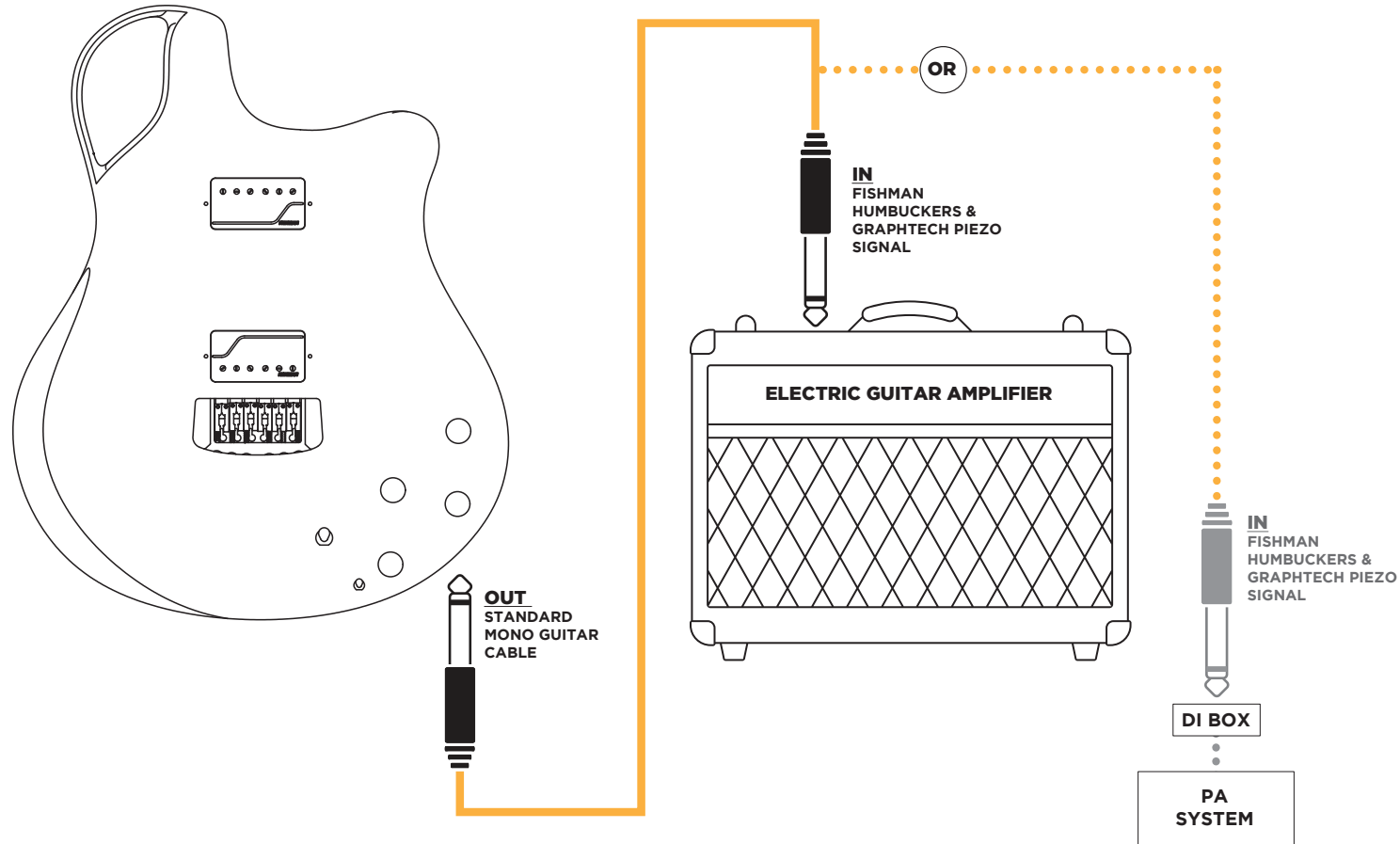

# CONFIGURATIONS: SETUP E

- 13 Pin Hexpander Only
- Route 13 Pin Cable to GR55 Guitar Synth
- Guitar out of GR55 to Guitar Amp sends Piezo and Humbucker signals individually from Synth signal
- Synth output sends synth only to DI/Acoustic Amp/PA

